

WOODBIDGE

ASSEMBLY INSTRUCTIONS FOR

5107-55

Villeret Café Table

Thank you for purchasing Woodbridge Furniture. Be sure to check all packing materials carefully to ensure proper assembly.

Please read all instructions carefully before starting the assembly process. Some parts are large and heavy and require at least two people to assemble, to prevent possible injury and/or damage to the furniture.

PARTS LIST

NO.	DESCRIPTION	QTY	NOTE
A	Base	1	
B	Top	1	

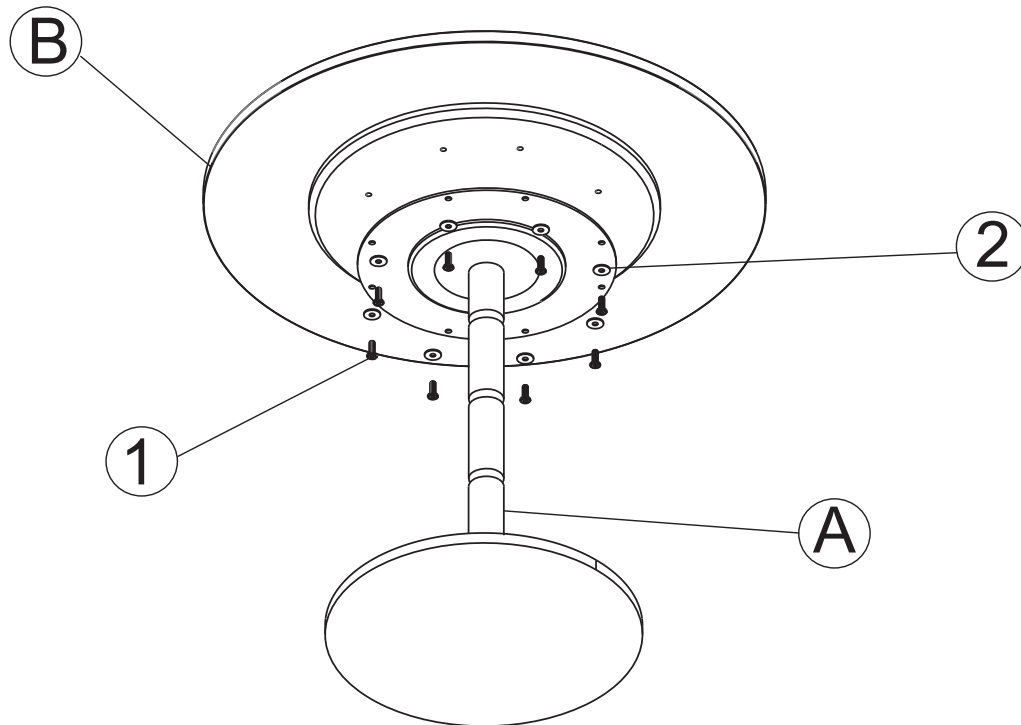

Components

NO.	DESCRIPTION	SIZE	QTY
1	Round Head Screws	M8x20mm	8
2	Washers	M8	8

ASSEMBLY INSTRUCTIONS

1. Place the base (A) on a flat surface.
2. Position the top onto the base, ensuring that all holes are properly aligned
3. Start assembling the base (A) and the top (B) with 8 round-head screws (1) and 8 washers (2). Tighten all screws in a clockwise direction to secure the parts firmly, as shown.